

# BOWMAN BUSINESS CENTER

10210 Governor Lane Blvd. Williamsport, MD 21795

Bowman Business Park is a well established park with attractive brick masonry buildings with dark green metal mansard roofs visible from Interstate 81.

Currently Available:  
Suite – 3 offices – 580SF  
Single office – 481SF  
Single office – 173SF  
Single office – 164SF



## HIGHLIGHTS

- Large Conference Room, Kitchenette & Employee Break Room
- Ample parking available
- Interstate 81 Pylon Signage available



For leasing information:

Rob Ferree

p. 301-223-1090

e. rferree@dmbowman.com



# BOWMAN BUSINESS CENTER

10210 Governor Lane Blvd. Williamsport, MD 21795



For leasing information:  
Rob Ferree p. 301-223-1090 e. rferree@dmbowman.com

# BOWMAN BUSINESS CENTER

10210 Governor Lane Blvd. Williamsport, MD 21795

## Currently Available Floor Plan

### EXHIBIT "A"



**BOWMAN BUSINESS PARK**  
10210 GOVERNOR LANE BOULEVARD  
SUITE 2005  
WILLIAMSPORT, MD 21795

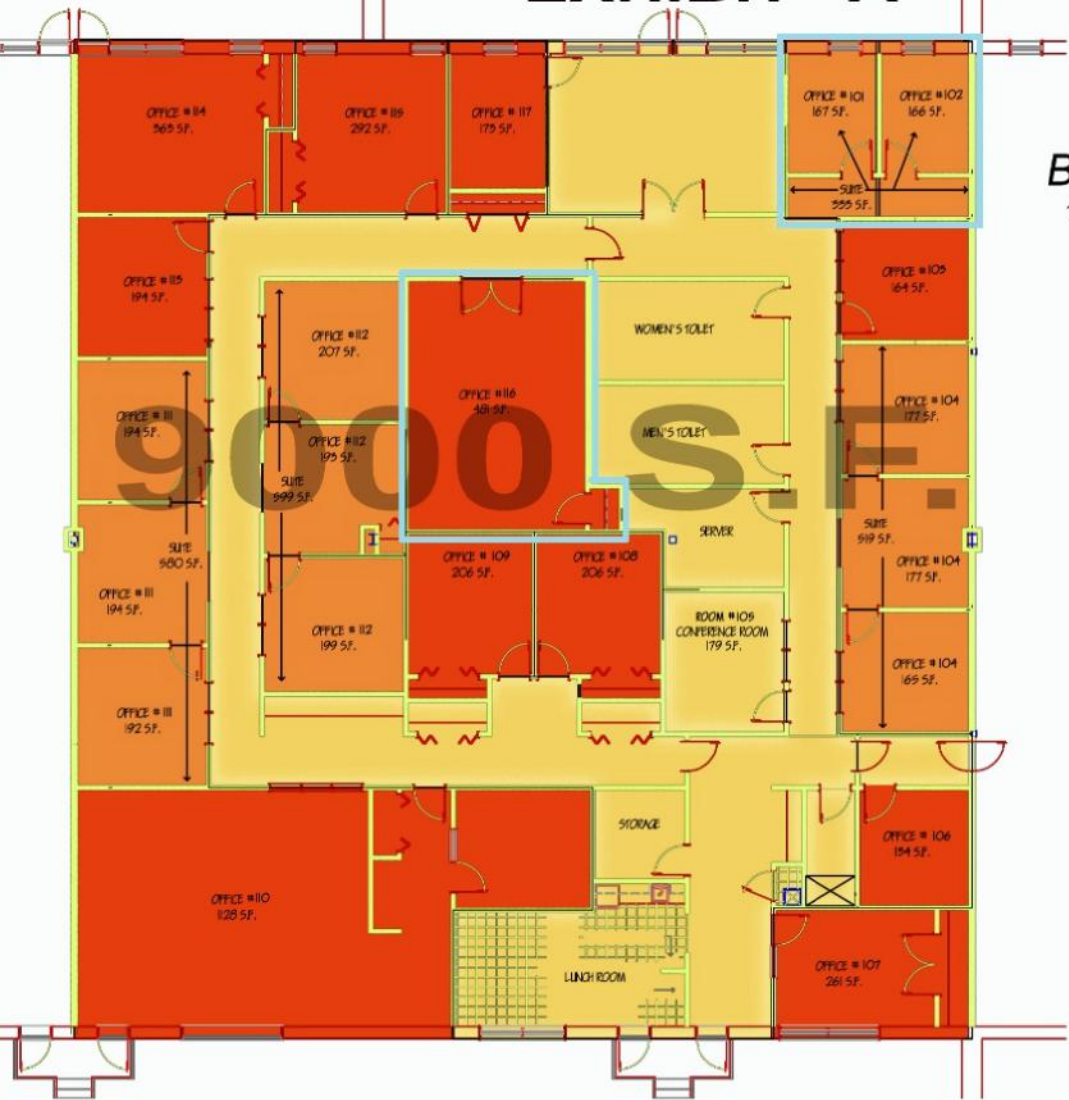

- COMMON AREAS
- INDIVIDUAL OFFICES
- SUITE OFFICES



For leasing information:

Rob Ferree      p. 301-223-1090      e. rferree@dmbowman.com