

BOWMAN BUSINESS CENTER

10210 Governor Lane Blvd. Williamsport, MD 21795

Bowman Business Park is a well established park with attractive brick masonry buildings with dark green metal mansard roofs visible from Interstate 81.

Currently Available:

Office 113- 194 SF

Office 116- 481 SF

Two Suite Office (101&102)- 333 SF

Three Suite Office (111)- 580 SF



HIGHLIGHTS

- Large Conference Room, Kitchenette & Employee Break Room
- Ample parking available
- Interstate 81 Pylon Signage available



For leasing information:

Rob Ferree

p. 301-223-1090

e. rferree@dmbowman.com

BOWMAN BUSINESS CENTER

10210 Governor Lane Blvd. Williamsport, MD 21795



For leasing information:
Rob Ferree p. 301-223-1090 e. rferree@dmbowman.com

BOWMAN BUSINESS CENTER

10210 Governor Lane Blvd. Williamsport, MD 21795

Currently Available Floor Plan

EXHIBIT "A"



BOWMAN BUSINESS PARK
10210 GOVERNOR LANE BOULEVARD
SUITE 2005
WILLIAMSPORT, MD 21795

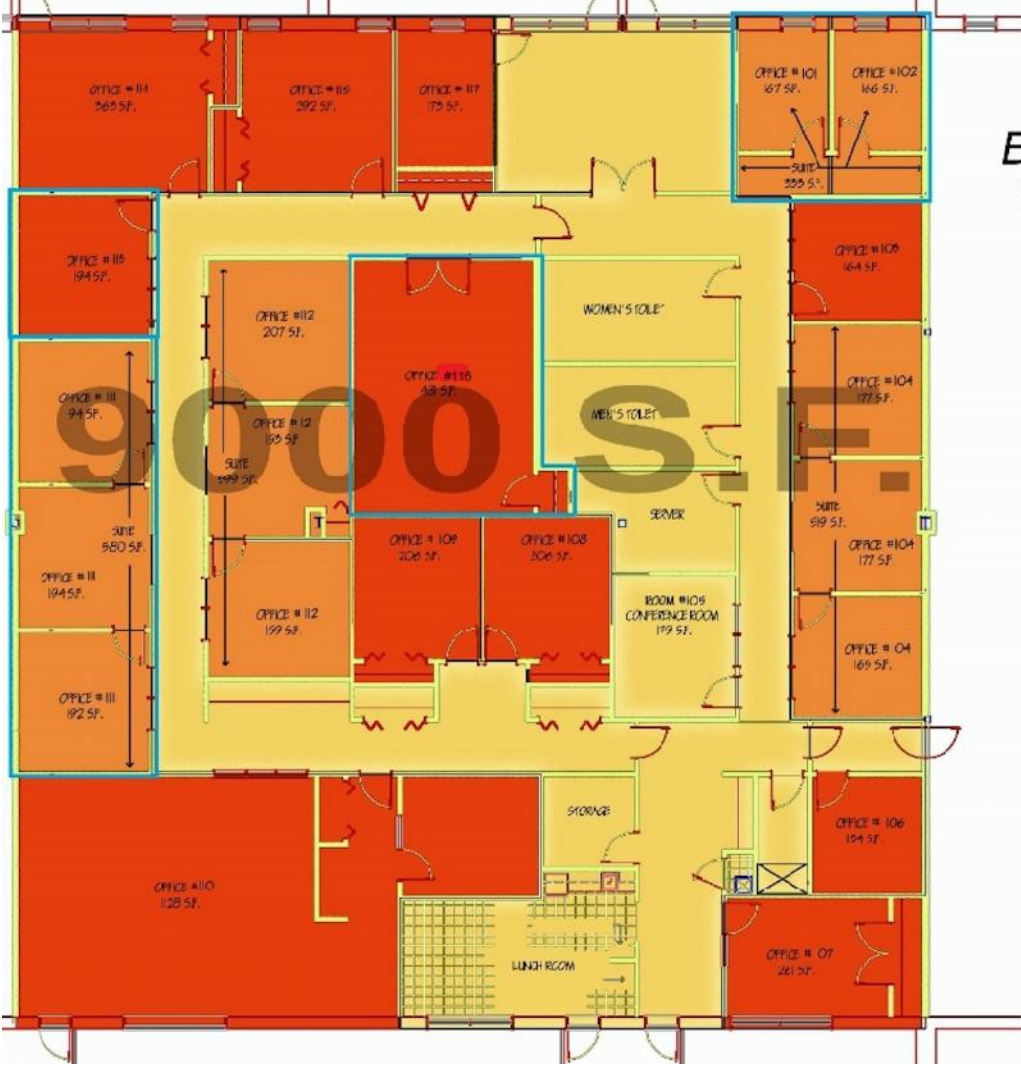

- COMMON AREAS
- INDIVIDUAL OFFICES
- SUITE OFFICES



For leasing information:
Rob Ferree p. 301-223-1090 e. rferree@dmbowman.com